

CONTROL JOINT  
SCALE 1:15

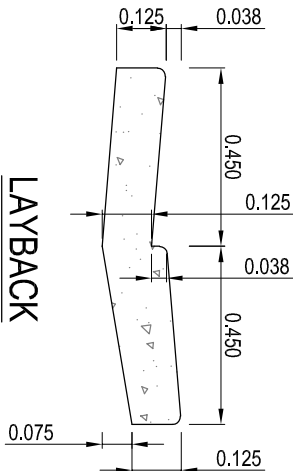

LAYBACK  
SCALE 1:20

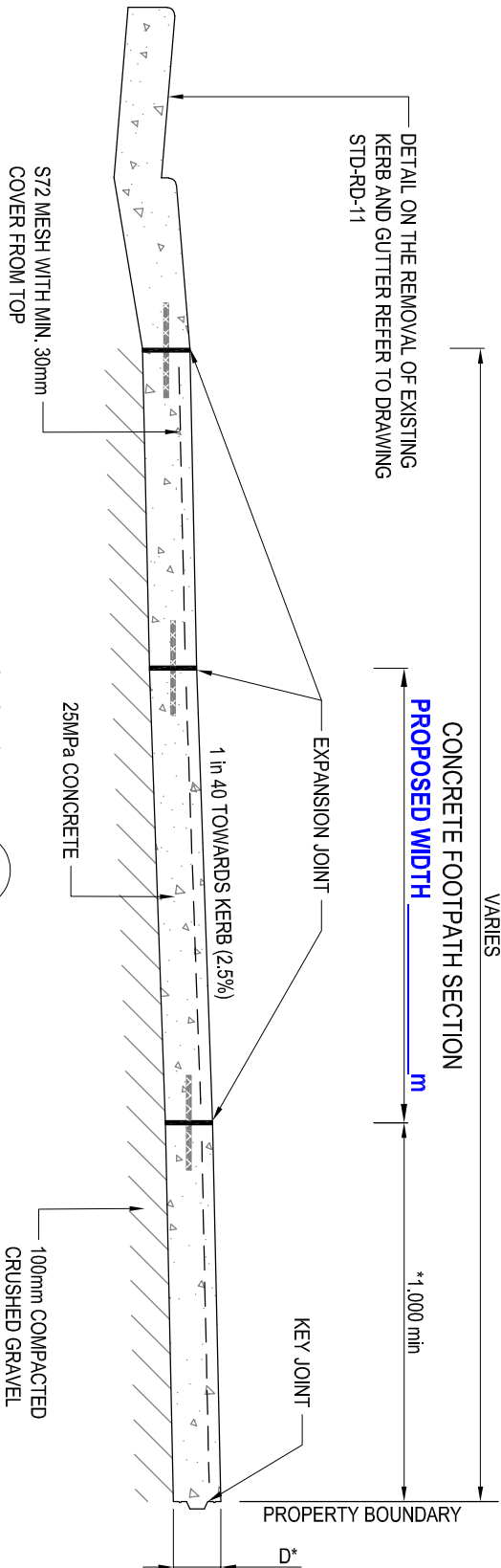

SECTION A  
SCALE 1:20

- \* DIMENSION D IS SELECTED AS FOLLOWS:
- RESIDENTIAL DRIVEWAY FOOTPATHS TO BE 125mm THICK CONCRETE WITH 100mm CRUSHED GRAVEL
  - HEAVY INDUSTRIAL DRIVEWAY FOOTPATHS TO BE 150mm THICK CONCRETE WITH 100mm CRUSHED GRAVEL

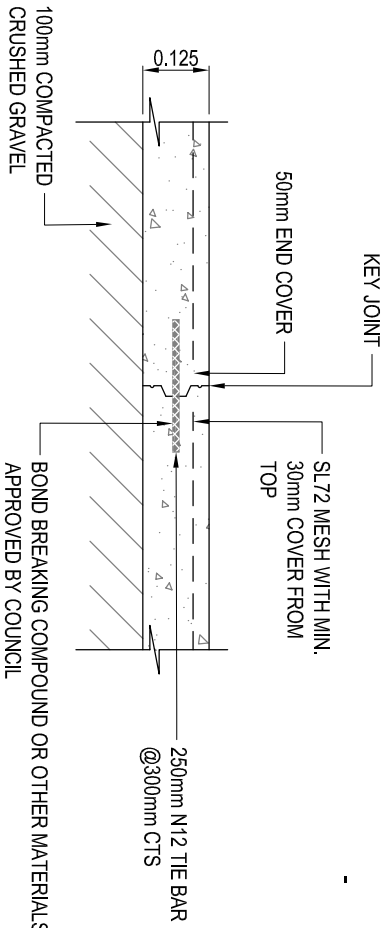

KEY JOINT  
SCALE 1:15

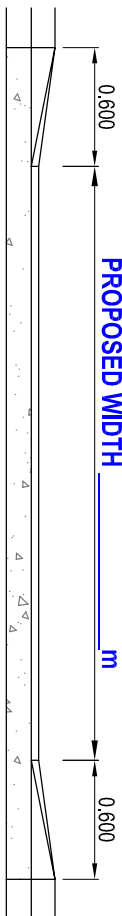

SECTION B  
SCALE 1:40

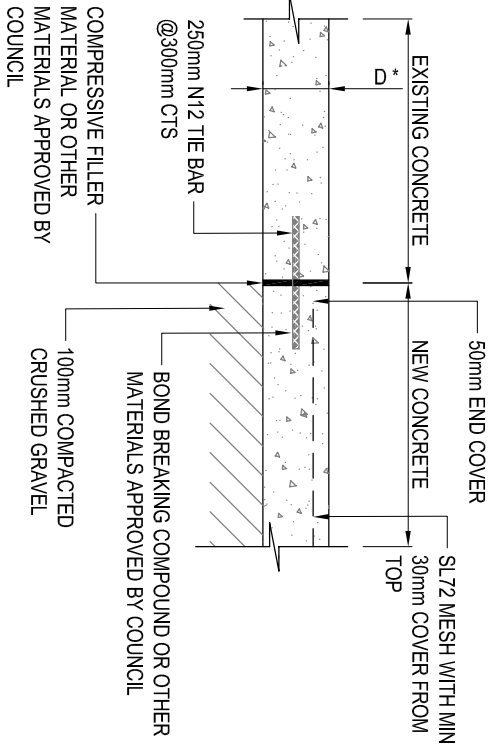
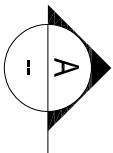

EXPANSION JOINT  
SCALE 1:15

- NOTES
1. THE FINISHED LEVEL OF THE DRIVEWAY AT THE PROPERTY BOUNDARY SHALL BE MAX. 130mm ABOVE TOP OF KERB.
  2. \*\* 1000mm MIN. FROM THE PROPERTY BOUNDARY, WHERE THIS CAN NOT BE ACHIEVED WRITTEN CONSENT IS REQUIRED FROM COUNCIL.
  3. FOR FURTHER FOOTPATH DETAILS REFER TO DRAWINGS STD-RD-005, STD-RD-006 AND STD-RD-007.
  4. SL72 MESH 25MPa CONCRETE.

RESIDENTIAL DRIVEWAY WITH FOOTPATH - PLAN  
SCALE 1:40

NOTE: ALL AREAS IN **BLUE** ABOVE MUST BE FILLED OUT AND ALL DETAILS BELOW.

SITE DETAILS: STREET NUMBER: \_\_\_\_\_ LOT NUMBER: \_\_\_\_\_ STREET NAME: \_\_\_\_\_ SUBURB: \_\_\_\_\_

STATEMENT OF COMPLIANCE: It is satisfied that the site was inspected and the proposed driveway can be constructed to comply with Council's Standard Drawing Numbers STD-RD-13, STD-RD-15, STD-RD-16, STD-RD-41.

FULL NAME: \_\_\_\_\_ COMPANY NAME: \_\_\_\_\_ POSITION: \_\_\_\_\_ SIGNATURE: \_\_\_\_\_ DATE: \_\_\_\_\_

DRAWING NUMBER:  
TEMPLATE 003