

- ## NOTES
1. DRIVEWAY ACCESS IS TO BE ALL WEATHER CONSTRUCTION OF A MINIMUM DEPTH OF 200mm COMPACTED ROAD GRAVEL
  2. WHERE THE ACCESS WAY CONNECTS TO A SEALED ROAD THE ACCESS WAY IS TO BE BITUMEN SEAL OR EQUIVALENT HARD SURFACE BETWEEN THE PROPERTY BOUNDARY AND THE ROAD CARRIAGEWAY.
  3. IN ORDER TO ACHIEVE MINIMUM OFFSET FROM CONCRETE DISH CROSSING TO EDGE OF ROAD CARRIAGEWAY, REDIRECTION OF TABLE DRAIN MAY BE REQUIRED AT THE CORRECT GRADE.
  4. 25MPa CONCRETE

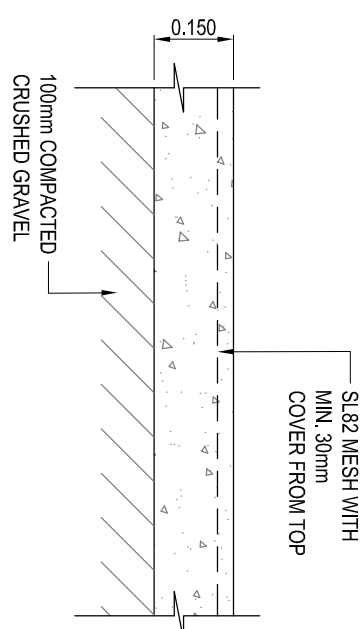

## RURAL DRIVEWAY - PLAN

SCALE 1:40

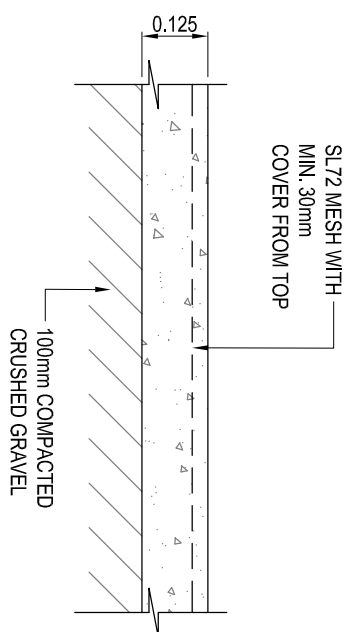
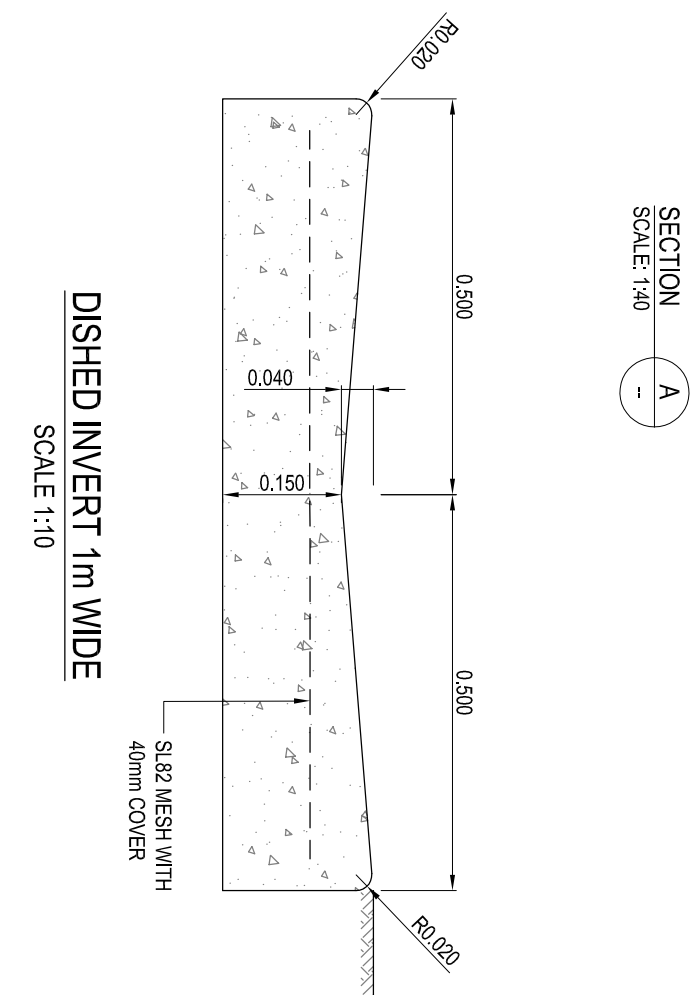
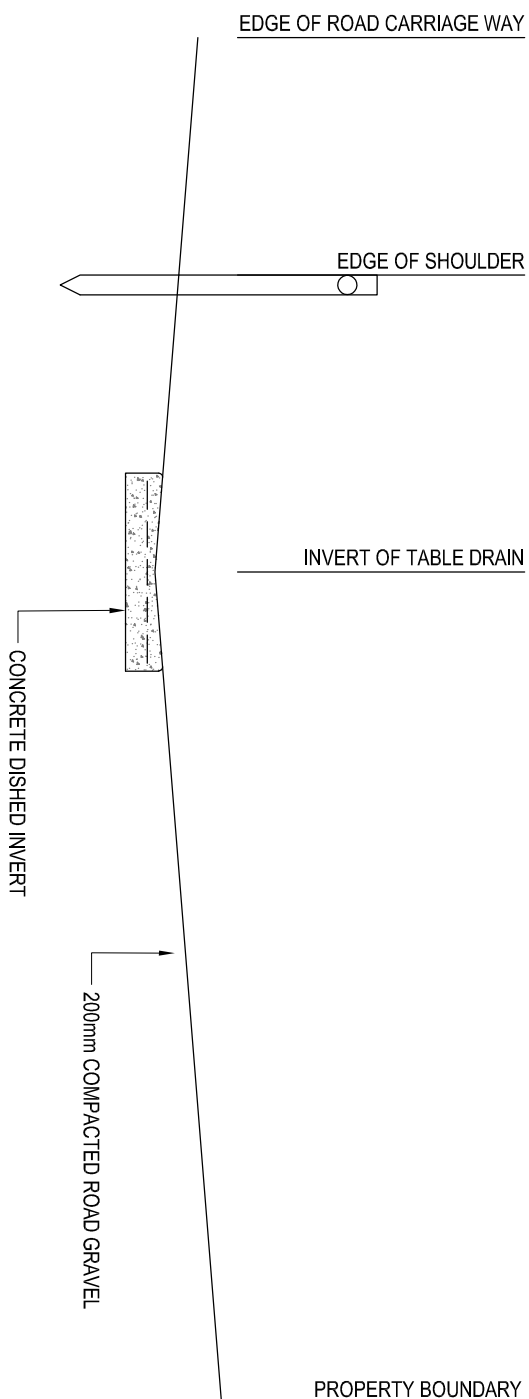
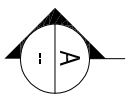

NOTE: ALL AREAS IN BLUE ABOVE MUST BE FILLED OUT AND ALL DETAILS BELOW.

**SITE DETAILS:** **STREET NUMBER:** \_\_\_\_\_ **LOT NUMBER:** \_\_\_\_\_

**STATEMENT OF COMPLIANCE:** It is satisfied that the site was inspected and the proposed driveway can be constructed to comply with Council's Standard Drawing Numbers STD-RD-18, STD-RD-41.

FULL NAME: \_\_\_\_\_ COMPANY NAME: \_\_\_\_\_

POSITION:

SUBURB:

SIGNATURE:

DATE:

DRAWING NUMBER:  
TEMPLATE 006