



**Apartment Housing Development
LANDSCAPE PLAN FOR DA APPROVAL**

Lot 1 Railway Street, Griffith NSW

DWG23047 LD01-03

Date: 22 May 2024 Revision: A

Prepared for Joss Construction by

YONDER LANDSCAPE ARCHITECTURE ©

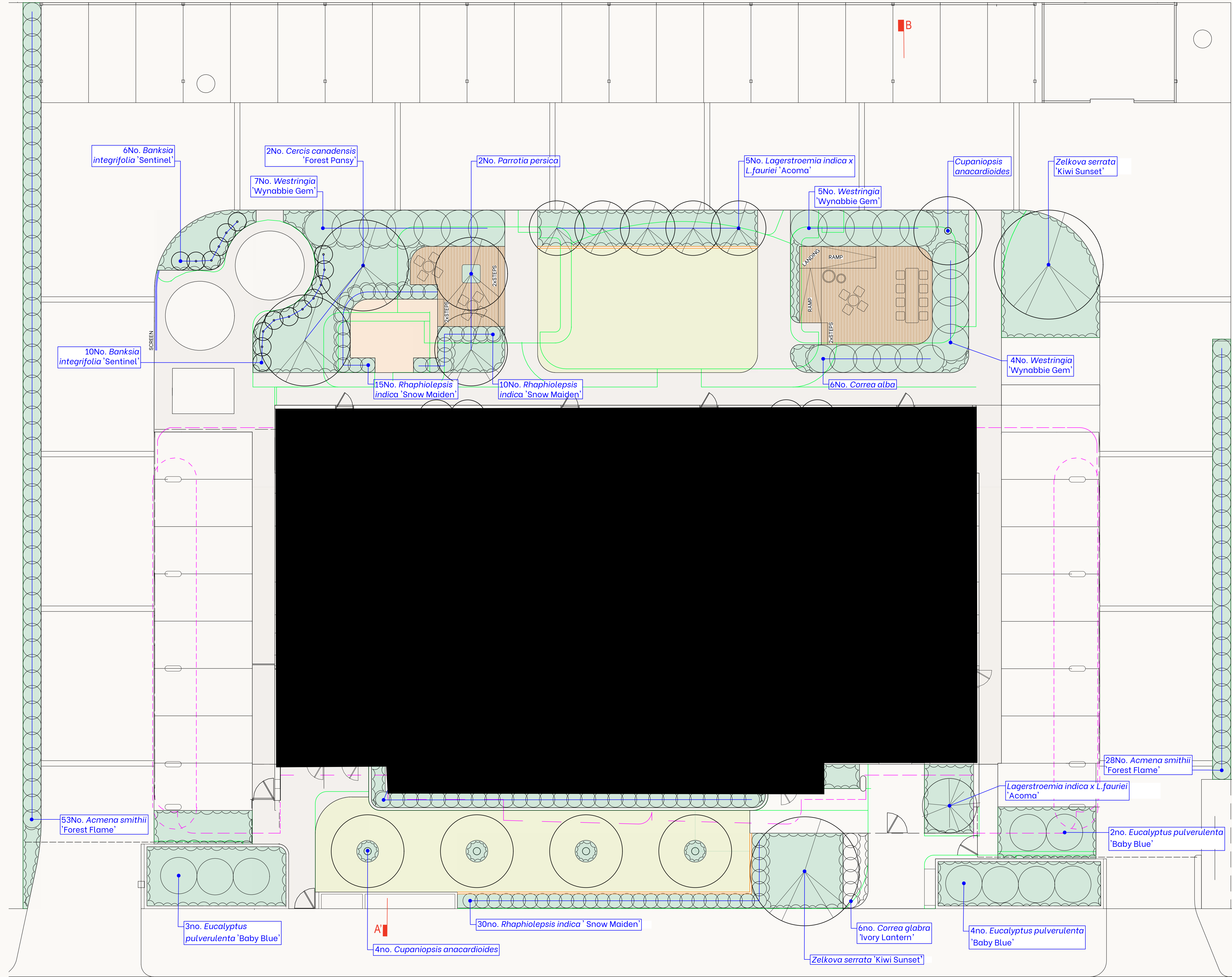

LEGEND

- Evergreen trees
- Deciduous trees
- Mulched garden beds
- Shrubs
- Groundcovers and tufted plants
- Climbers
- Rolled turf with edging
- Raised deck (+300mm)
- Path
- Feature paving

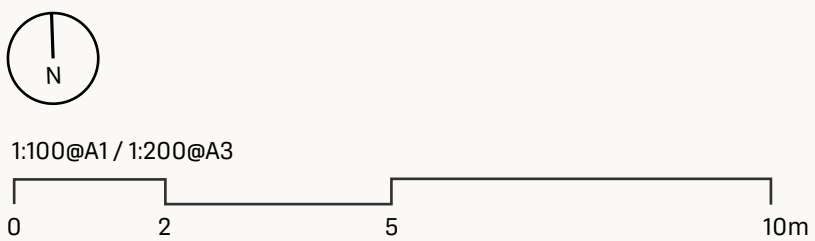

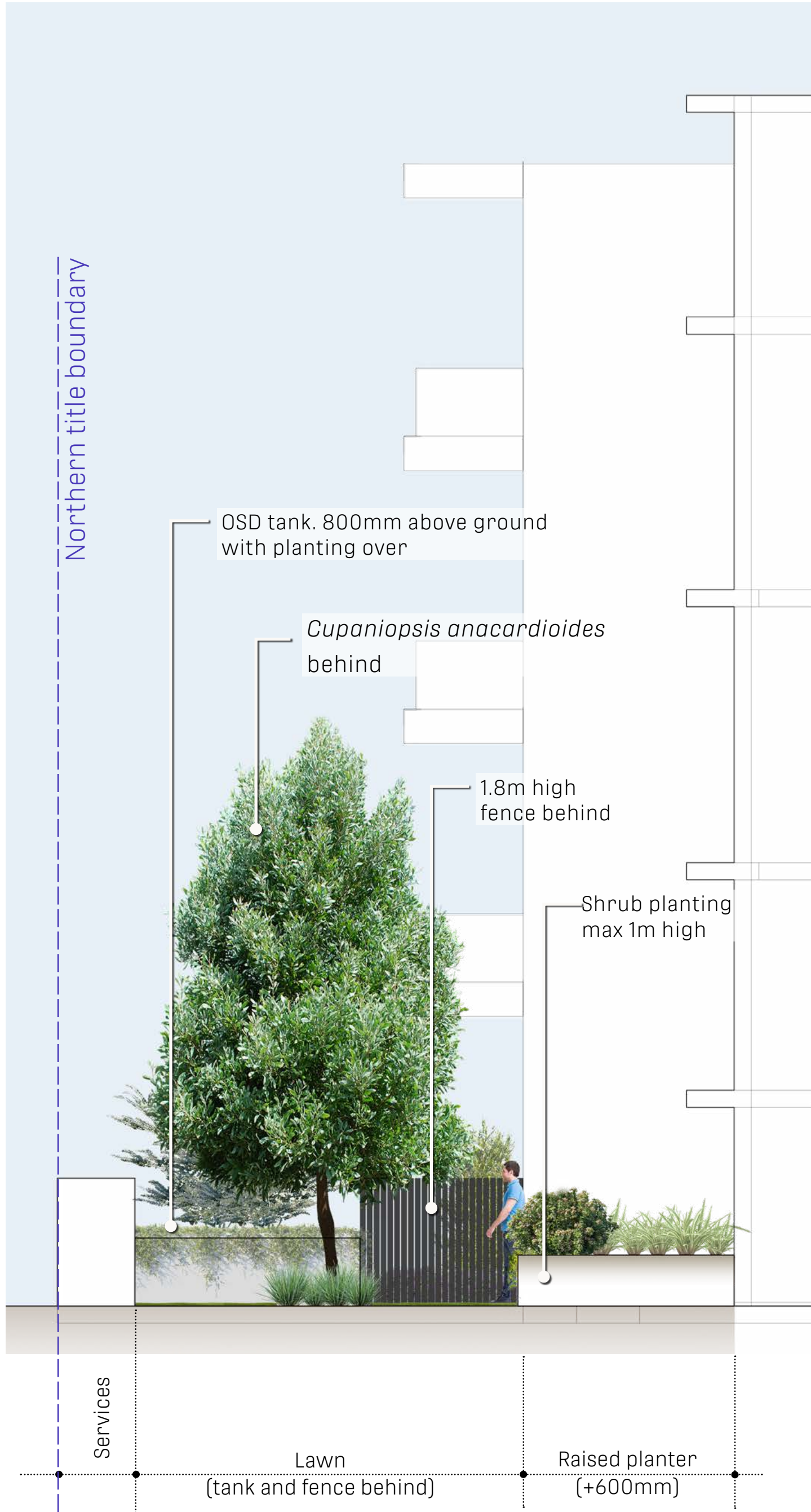

Section A - A'

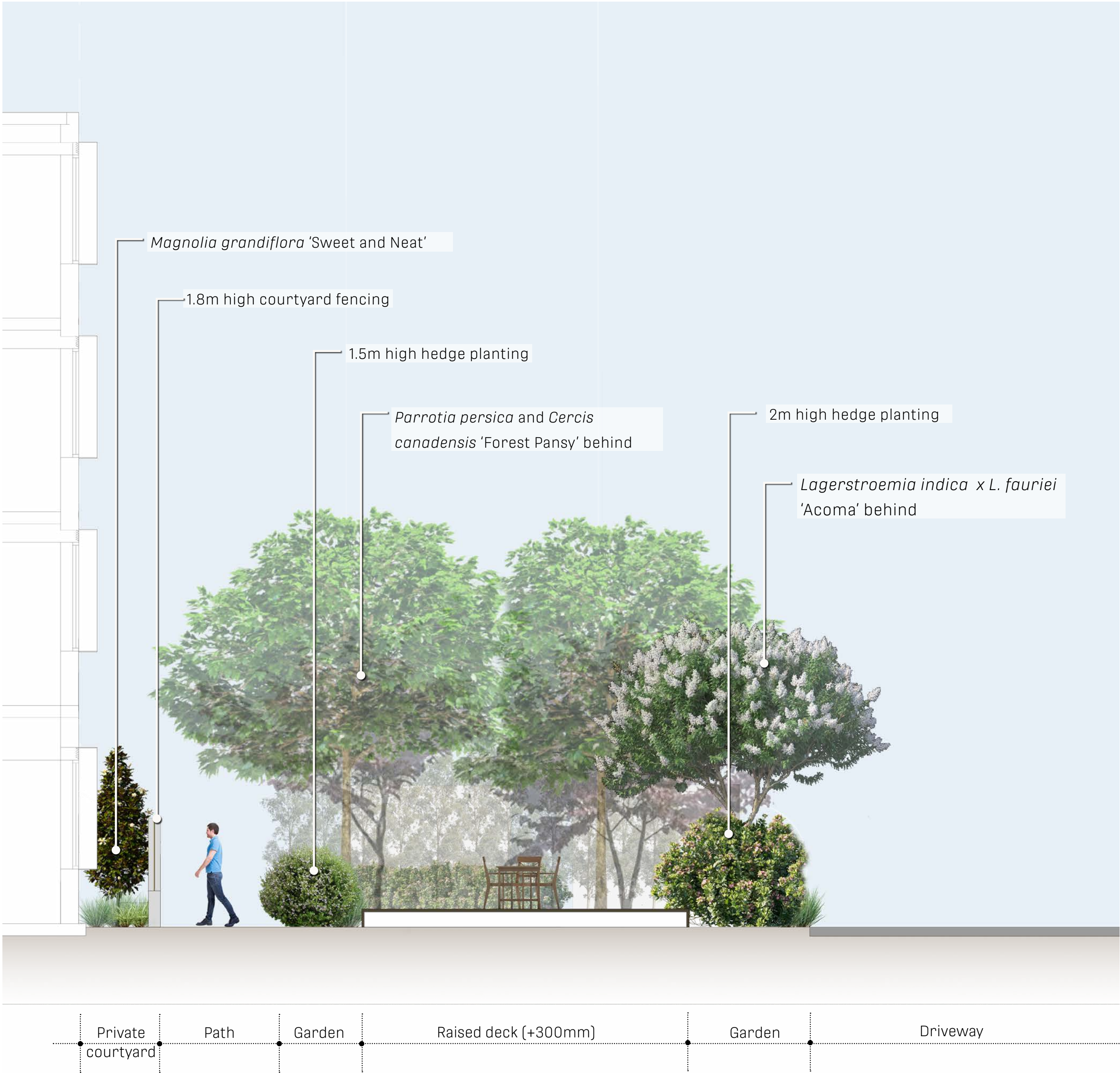

Section B - B'



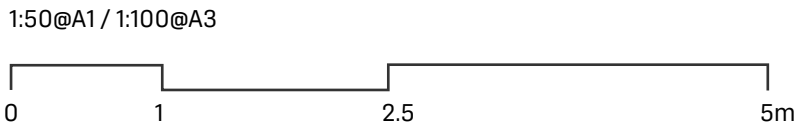



Sections



TREES

						
<i>Banksia integrifolia</i> 'Sentinel' FASTIGIATE BANKSIA H x S: 3m x 1m	<i>Cercis canadensis</i> 'Forest Pansy' FOREST PANSY H x S: 5m x 5m	<i>Cupaniopsis anacardioides</i> TUCKEROO H x S: 5-8m x 5-7m	<i>Lagerstroemia indica</i> x <i>L. fauriei</i> 'Acoma' CREPE MYRTLE H x S: 6m x 3m	<i>Magnolia grandiflora</i> 'Sweet and Neat' MAGNOLIA H x S: 3m x 6m	<i>Parrotia persica</i> PERSIAN IRONWOOD H x S: 7m x 5m	<i>Zelkova serrata</i> 'KIWI SUNSET' KIWI SUNSET JAPANESE ELM H x S: 10m x 6m

SHRUBS

						
<i>Acmena smithii</i> 'Forest Flame' LILLY PILLY H x S: 2m x 1m	<i>Anigozanthos flavidus</i> KANGAROO PAW H x S: 3m x 2m	<i>Correa alba</i> WHITE CORREA H x S: 1.5m x 1.5m	<i>Correa glabra</i> 'Ivory Lantern' IVORY LANTERN CORREA H x S: 0.6m x 0.6m	<i>Eucalyptus pulverulenta</i> 'Baby Blue' SILVER-LEAFED MOUNTAIN GUM H x S: 3m x 2m	<i>Metrosideros collina</i> 'MB01' PBR VELVET SKY H x S: 3m x 2m	<i>Raphiolepis indica</i> 'Snow Maiden' INDIAN HAWTHORN H x S: 1m x 1m

GROUNDCOVERS + CLIMBERS

						
<i>Callistemon hybrid</i> 'Red Rover' RED ROVER H x S: 0.4m x 1.5m	<i>Casuarina glauca</i> 'Cousin It' COUSIN IT H x S: 0.1-0.2m x 1-2m	<i>Hardenbergia violacea</i> 'Meema' HAPPY WANDERER H x S: 0.5m x 2m	<i>Lomandra filiformis</i> 'Savanna Blue' LOMANDRA H x S: 0.4m x 0.4m	<i>Lomandra</i> 'Verday' LOMANDRA H x S: 0.6m x 0.6m	<i>Parthenocissus henryana</i> CHINESE VIRGINIA CREEPER H x S: 0.4m x 4m	<i>Trachelospermum asicaticum</i> 'Flat Mat' PROSTRATE STAR JASMINE H x S: 0.4m x 4m